

4 LEVEL 3

- ▶ Schatten Gallery - rotating exhibits highlighting library collections
- ▶ Administrative offices
- ▶ Electronic classrooms
- ▶ Jones Room
- ▶ Emory Center for Digital Scholarship
- ▶ Learning Commons and quiet study

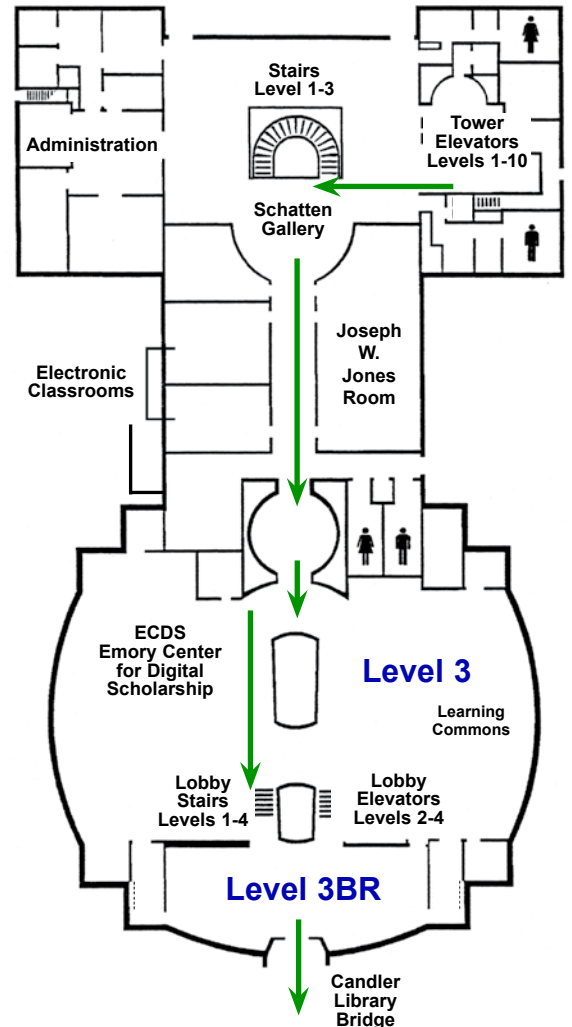

Take the Lobby steps up to Level 3BR and Candler Library

5 LEVEL 3BR and Candler Library

- ▶ Mezzanine and bridge - quiet study
- ▶ William L. Matheson Reading Room - current periodicals and newspapers

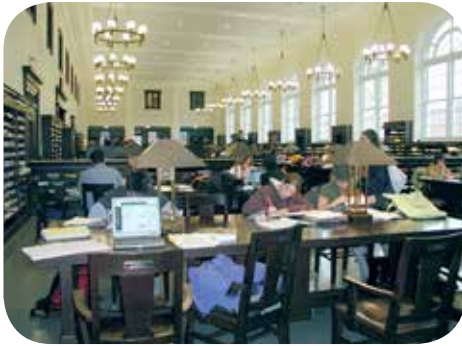

Return to 3BR and take the Lobby elevator up to Level 4

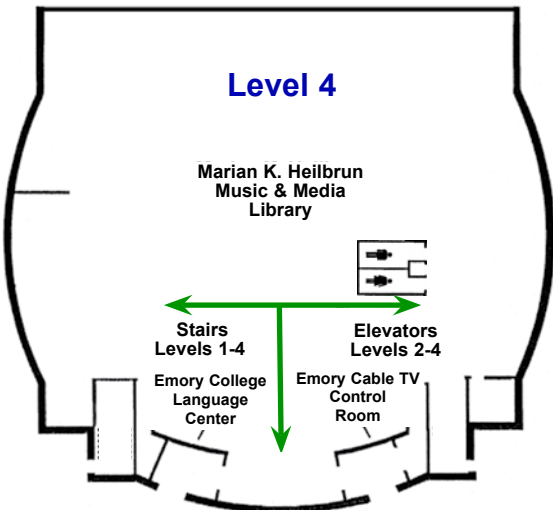

6 LEVEL 4 in Lobby

- ▶ Marian K. Heilbrun Music & Media Library
 - CD, DVD, film, and print collections
 - Reserves
 - Laptop and other equipment checkout
- ▶ Learning Commons
- ▶ Emory College Language Center
- ▶ Media Lab
- ▶ Emory Cable TV control room



Take Lobby elevator down to Level 2 to Exit

0816

Woodruff Library offers the full array of services and resources found in a major academic research library of the twenty-first century. Integrated services provided by library and information technology staffs, print and electronic resources, distinctive special and archival collections, technology centers, and comfortable study spaces combine to create an innovative, inviting environment for scholarly inquiry, research, and teaching.

The Goizueta Business Library; Marian K. Heilbrun Music and Media Library; Stuart A. Rose Manuscript, Archives, and Rare Book Library; and the Emory Center for Digital Scholarship are also housed in the complex. As many as 5,000 people use the library on site each day with twenty-four hour access, Learning Commons workstations on Levels 1-3, and wireless connectivity available on all floors.

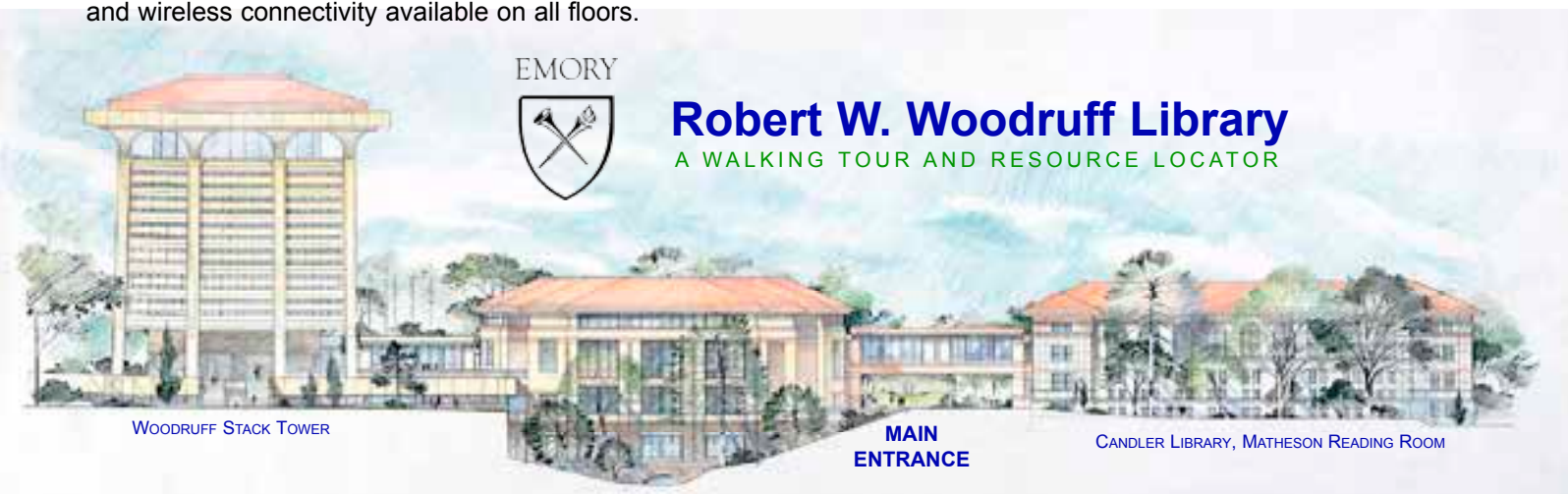

Robert W. Woodruff Library

A WALKING TOUR AND RESOURCE LOCATOR

WOODRUFF STACK TOWER

MAIN ENTRANCE

CANDLER LIBRARY, MATHESON READING ROOM

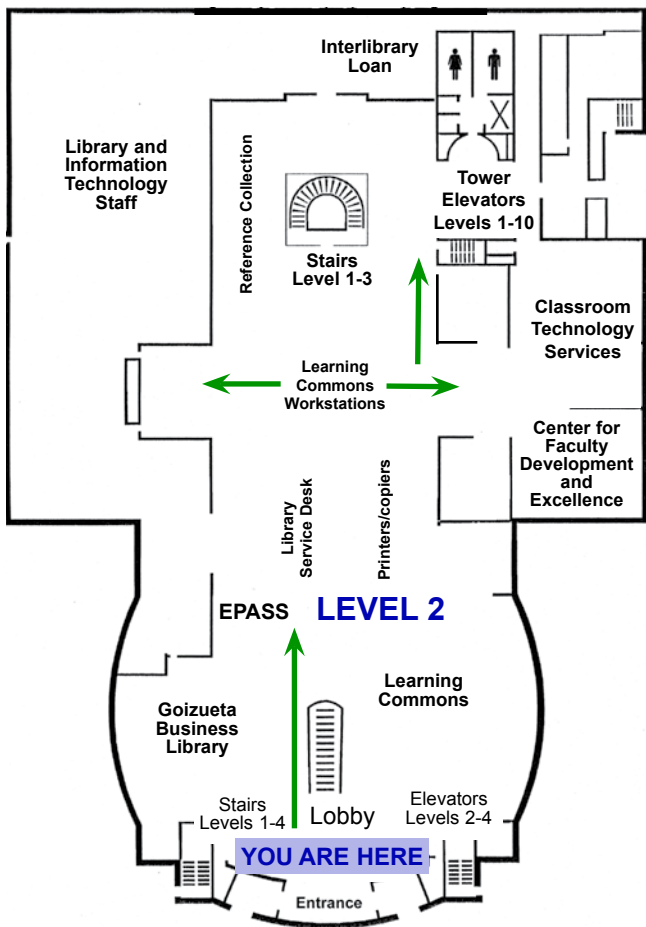

1 Level 2 Entrance

- ▶ **Entrance** - Use EmoryCard for access
 - Security Desk, Lost and Found
 - New Books Display
- ▶ **Goizueta Business Library**
 - Reference desk, reference collection, business databases, Career Resource Center, group study area
- ▶ **Learning Commons, including visitor workstations**
- ▶ **EPASS tutoring service**
- ▶ **Library service desk**
 - Checkouts and privileges
 - Research assistance
 - Computing and printing help
 - Interlibrary loan pickups
- ▶ **Center for Faculty Development and Excellence**
- ▶ **Classroom Technology Services**
- ▶ **Interlibrary Loan Office**



Take Woodruff Tower elevator down to Level 1

2 Level 1

- ▶ Chinese Cultural Exploratorium
- ▶ Learning Commons
- ▶ Coffee shop
- ▶ Microforms and readers
- ▶ Student technology services
- ▶ Government documents collection
 - Census, legislative, statistical and foreign policy documents

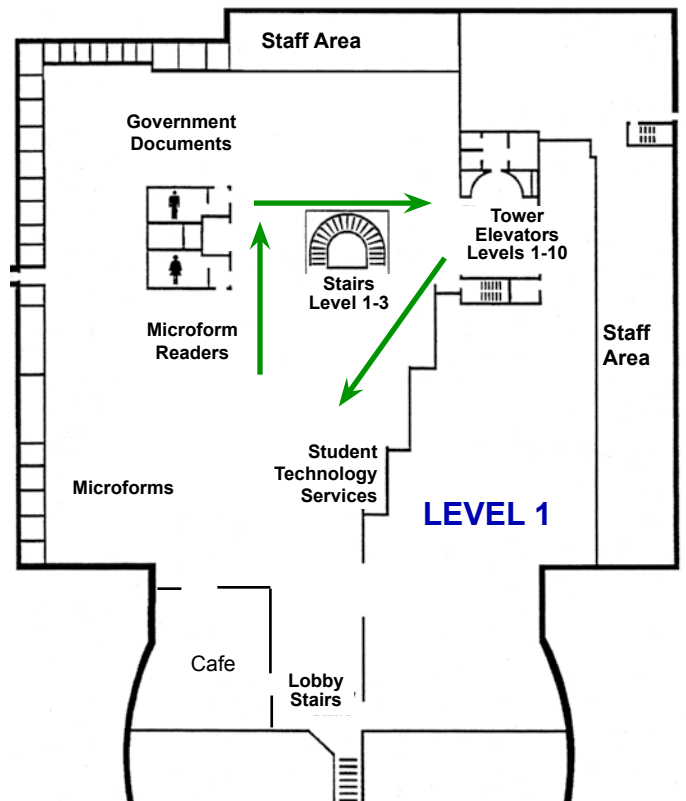

Take Woodruff Tower elevator up to Levels 4-8

3 Woodruff Tower

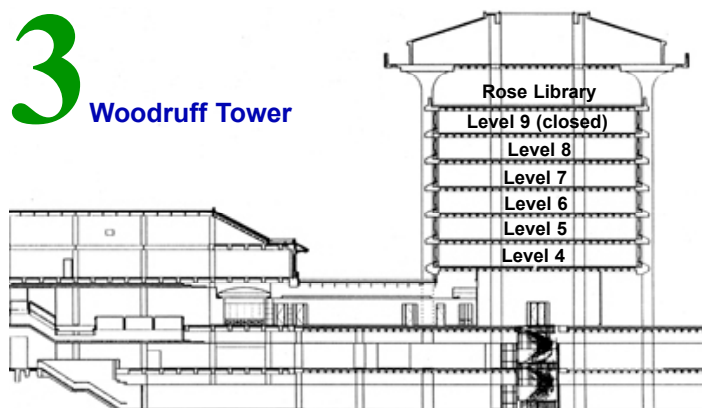

Levels 4-8 of the Woodruff Stack Tower

- Book stacks
- Catalog terminals
- Group studies
- Graduate and Faculty Studies
- Study carrels
- Classrooms on levels 7-8



Take Woodruff Tower elevator up to Level 10 to the Stuart A. Rose Manuscript, Archives, and Rare Book Library

Level 10, Stuart A Rose Manuscript, Archives, and Rare Book Library

- Emory archives, rare books, and manuscript collections, especially in the areas of African American Culture, Modern Literature, and Southern History
- Rotating and permanent exhibits
- Views of campus and the city skyline

Take Woodruff Tower elevator down to Level 3

